

1- **K46CI Transmission**

K46CI Seal Kit

Kit Includes

#17	#72
#19	#81
#20	#91
#26	#99
#59	

All parts may not be used.

200-

K46CI Repair Kit

Kit Includes

#24	#38
#31	
#200 - Seal Kit	

All parts may not be used.

201-



Utgåva Issue		Bildnr Picture No		KANZAKI TRANSAXEL K46CI (s/n 0100000- 9999999)		KANZAKI TRANSAXLE K46CI (s/n 0100000- 9999999)		Sida Page	
2011- 11		2547A						434	
Pos. Fig.	Antal/Quantity				Art nr Part No	Benämning	Description	Sats Kit	Anmärkning Notes
	K46 CI								
1	1			1137-0123-01	Transaxel kpl.....	Transaxle assy.....		Kanzaki K46CI	
2	1			1139-1470-01	Hus- övre	Housing- upper			
3	1			1139-1402-01	Hus- nedre	Case- lower			
5	1			1139-1301-01	Rör	Tube			
6	2			1139-1336-01	Slangklämma.....	Hose clamp			
8	2			1139-1150-01	Magnet	Magnet.....			
9	1			1139-1341-01	Hållare- magnet	Holder- magnet			
11	1			1139-1347-01	Fjäder.....	Spring			
12	1			1139-1251-01	Axel- bypass	Shaft- bypass			
13	1			1139-1189-01	Arm- bypass	Lever- bypass			
14	1			1139-1161-01	Låsring	Ring			
15	1			1139-1275-01	Plugg.....	Bore plug			
16	1			1139-1104-01	• Låsring	• Snap ring			
17	2			1139-1103-01	• Tätningsbricka	• Seal washer	S		
18	2			1139-1500-01	Dräneringsskruv	Drain bolt kit			
19	2			1139-1117-01	• O- ring	• O- ring	S		
20	1			1139-1119-01	• Tätning	• Seal	S		
21	2			1139-1295-01	Skruv	Tapping screw			
22	14			1139-0244-01	Skruv	Tapping screw			
24	1			1139-1599-01	• Centrumhus	• Center case	R		
25	1			1139-1158-01	Stift	Pin			
26	1			1139-1405-01	• Filter	• Filter	S		
27	3			1139-1718-01	Bult	Bolt			
28	2			1139-1468-01	Ventil	IDS valve			
29	2			1139-1243-01	Fjäder.....	Spring			
30	2			1139-1307-01	Filter	Filter			
31	1			1139-1601-01	• Cylinderblock (pump)	• Cylinder block (pump).....	R		
32	1			1139-1245-01	Fjäder.....	Spring			
34	3			1139-1146-01	• Låsring	• Ring			
35	1			1139-1110-01	• Kullager	• Ball bearing			
36	1			1139-1157-01	Hus	Housing			
37	1			1139-1501-01	Lager	Bearing.....			
38	1			1139-1717-01	Cylinderblock (motor).....	Cylinder block (motor)	R		
39	1			1139-1160-01	Bricka	Washer.....			
40	1			1139-1353-01	Motoraxel	Motor shaft			
41	1			1139-1021-01	Låsring	Snap ring			
42	1			1139-1272-01	Motordrev	Motor gear			
43	1			1139-1453-01	Lager	Bearing.....			
44	2			1139-1066-01	Tryckplatta	Metal thrust			
45	1			1139-1597-01	Stänkplatta	Swash plate.....			
46	1			1139-1508-01	Lager	Thrust bearing kit.....			
47	1			1139-1598-01	Magnethållare.....	Magnet holder			
49	1			1139-1354-01	Regleraxel.....	Control shaft			
50	1			1139-1410-01	Excenter.....	Fulcrum.....			
51	1			1139-1312-01	Fjäder.....	Spring			
52	1			1139-1409-01	Reglerarm.....	Control arm			
53	1			1139-1325-01	Reglerarm.....	Control lever			
54	1			1139-1596-01	Ryckplatta	Jerky plate			
55	1			1139-1102-01	Bricka	Washer.....			
56	1			1139-1355-01	Saxpinne.....	Cotter pin			
57	1			1139-1329-01	Stift	Pin			
58	1			1139-1285-01	Stift.....	Pin			
59	2			1139-1115-01	• O- ring.....	• O- ring	S		
60	1			1139-1127-01	Mutter.....	Nut			
61	1			1139-1404-01	Differentialdrev kpl	Differential gear kit.....			
62	1			1139-1258-01	Slutdrev	Final gear			
63	1			1139-1255-01	Hylsa	Collar			
64	1			1139-1256-01	Reduktionsaxel	Reduction shaft.....			
65	2			1139-1398-01	Bricka	Washer.....			
66	1			1139-1267-01	Reduktionsdrev	Reduction gear.....			
67	1			1139-1361-01	Slutdrev	Final pinion			
68	1			1139-1344-01	Hjulaxel- vän.....	Axle shaft- left			
69	1			1139-1345-01	Hjulaxel- hö.....	Axle shaft- right.....			

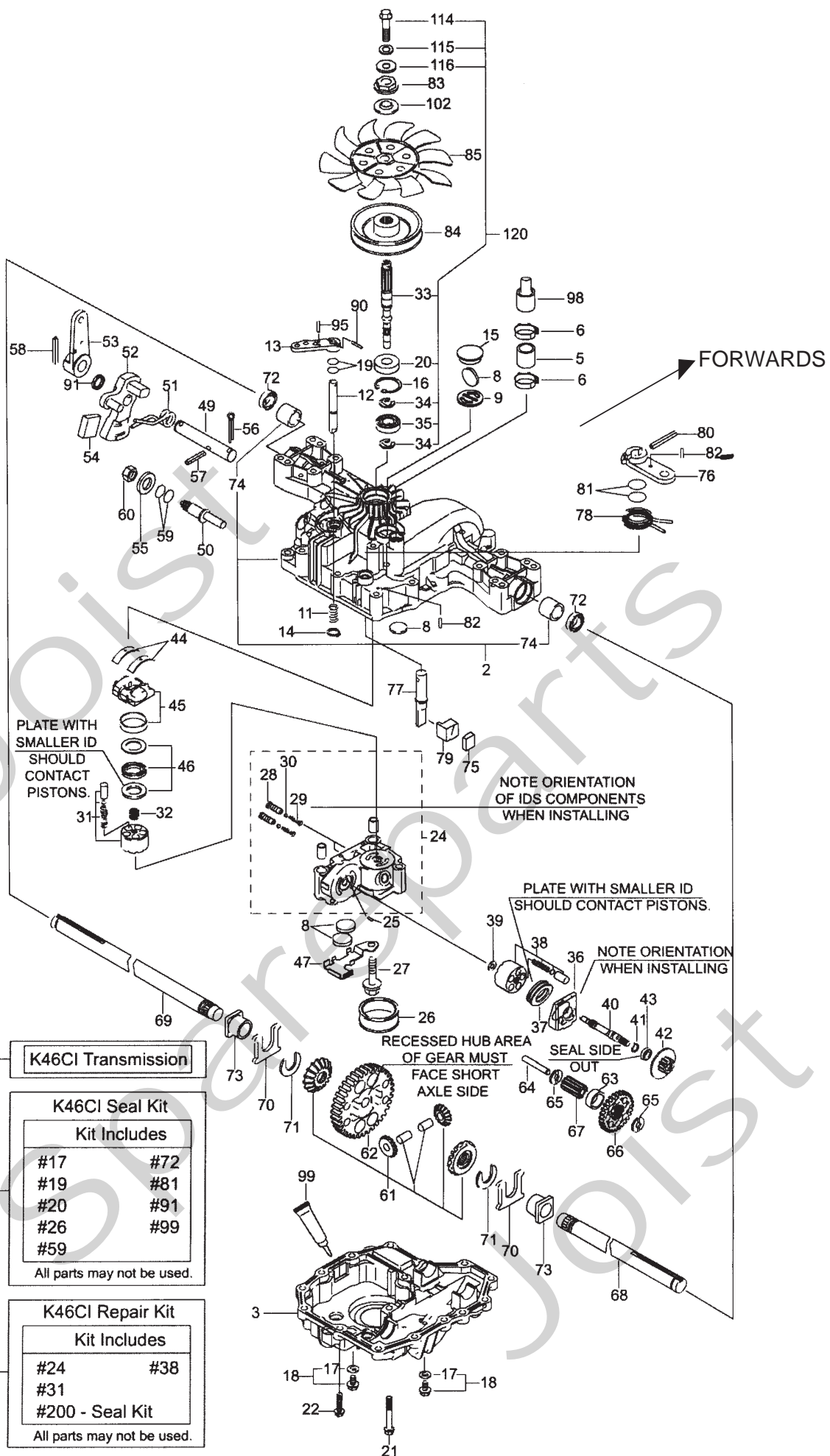

1- K46CI Transmission

200- K46CI Seal Kit

Kit Includes	
#17	#72
#19	#81
#20	#91
#26	#99
#59	

All parts may not be used.

201- K46CI Repair Kit

Kit Includes	
#24	#38
#31	
#200 - Seal Kit	

All parts may not be used.



Utgåva Issue		Bildnr Picture No		KANZAKI TRANSAXEL K46CI (s/n 0100000- 9999999)		KANZAKI TRANSAXLE K46CI (s/n 0100000- 9999999)		Sida Page	
2011- 11		2547A						436	
Pos. Fig.	Antal/Quantity				Art nr Part No	Benämning	Description	Sats Kit	Anmärkning Notes
	K46 CI								
70	2			1139- 1078- 01	Tryckbricka	Thrust washer			
71	2			1139- 1163- 01	Låsring	Ring			
72	2			1139- 1080- 01	• Tätning	• Seal	S		
73	2			1139- 1164- 01	Bussning	Bushing			
74	2			1139- 1414- 01	• Bussning.....	• Bushing.....			
75	1			1139- 1260- 01	Bromssko	Brake shoe			
76	1			1139- 1261- 01	Bromsarm	Brake arm			
77	1			1139- 1320- 01	Bromsaxel	Brake shaft.....			
78	1			1139- 1411- 01	Returfjäder	Return spring			
79	1			1139- 1264- 01	Bromstryckare	Brake actuator			
80	1			1139- 1282- 01	Stift.....	Pin			
81	2			1139- 1114- 01	• O- ring.....	• O- ring	S		
82	2			1139- 1281- 01	Stift.....	Pin			
83	1			1139- 1248- 01	Krage.....	Spline collar			
84	1			1139- 1484- 01	Remskiva.....	Belt pulley			
85	1			1134- 4190- 01	Fläkt.....	Fan			
90	1			1139- 1280- 01	Stift.....	Pin			
91	1			1139- 1303- 01	• Tätningring	• Oil seal	S		
95	1			1139- 1279- 01	Stift.....	Pin			
98	1			1139- 1306- 01	Adapter.....	Adapter			
99	1			1139- 1443- 01	• Tätningmedel	• Sealant	S		
102	1			1139- 1276- 01	Bricka	Collar			
X 114	1			1139- 1719- 01	• Bult	• Bolt			
X 115	1			1139- 1720- 01	• Låsbricka	• Lock washer			
X 116	1			1139- 1721- 01	• Bricka	• Washer			
120	1			1139- 1606- 01	Pumpaxel.....	Pump shaft kit.....			
200	1			1139- 1403- 01	Packningssats	Seal kit	R	Märkta S/Marked S	
201	1			1139- 1600- 01	Rep.sats	Repair kit.....		Märkta R/Marked R	

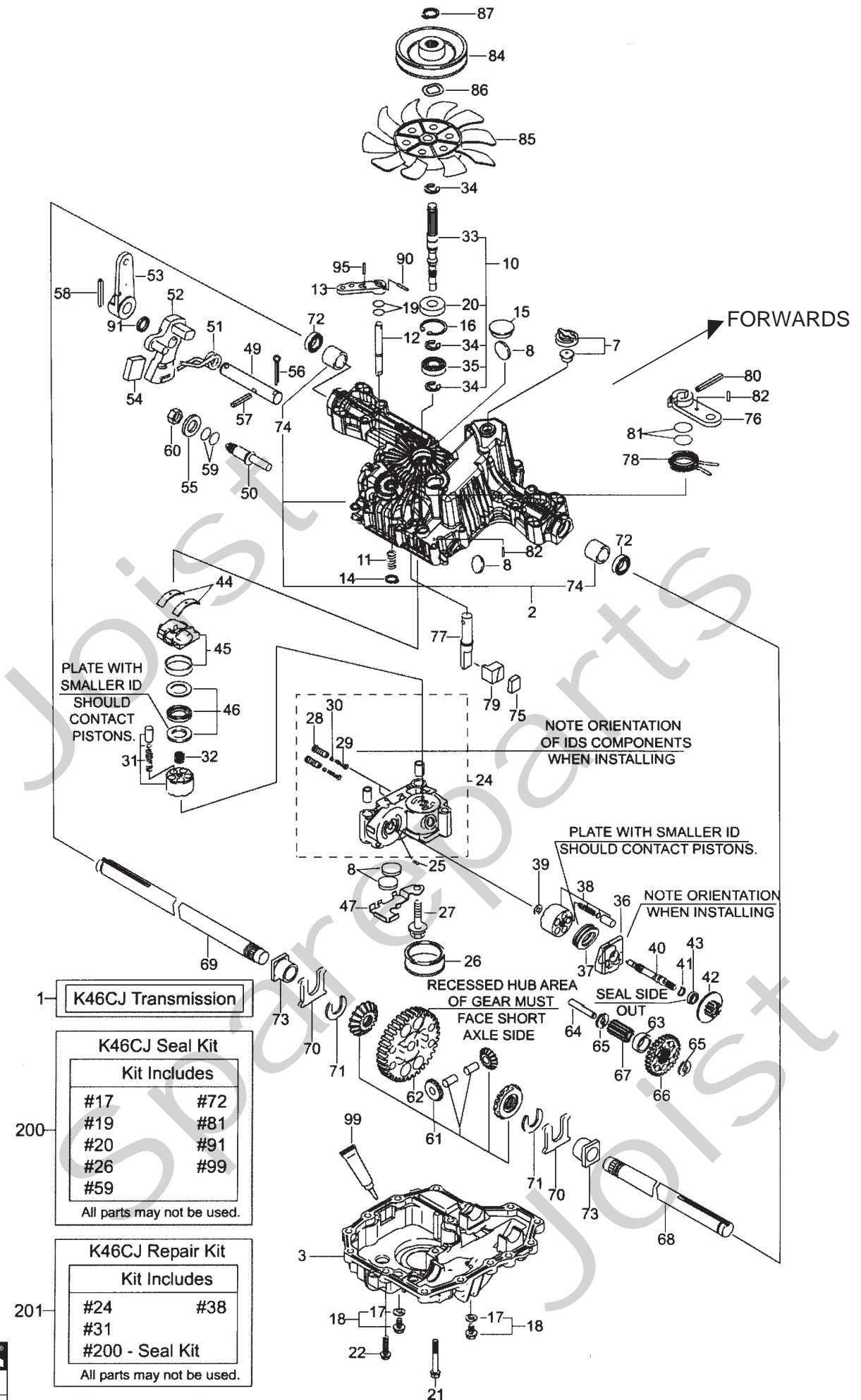

1 K46CJ Transmission

200 K46CJ Seal Kit

Kit Includes

#17	#72
#19	#81
#20	#91
#26	#99
#59	

All parts may not be used.

201 K46CJ Repair Kit

Kit Includes

#24	#38
#31	
#200 - Seal Kit	

All parts may not be used.

Utgåva Issue		Bildnr Picture No		KANZAKI TRANSAXEL K46CJ (s/n 0014070- 9999999)		KANZAKI TRANSAXLE K46CJ (s/n 0014070- 9999999)		Sida Page	
2011- 11		2546A						438	
Pos. Fig.	Antal/Quantity				Art nr Part No	Benämning	Description	Sats Kit	Anmärkning Notes
	K46 CJ								
1	1			1134-7766-01	Transaxel kpl.....	Transaxle assy.....		Kanzaki K46CJ	
2	1			1139-1485-01	Hus- övre	Housing- upper			
3	1			1139-1402-01	Hus- nedre	Case- lower			
7	1			1139-1595-01	Ventil	Vent valve.....			
8	2			1139-1150-01	• Magnet	• Magnet	S		
10	1			1139-1499-01	Pumpaxel kpl.....	Pump shaft kit.....			
11	1			1139-1347-01	Fjäder.....	Spring			
12	1			1139-1324-01	Axel- bypass	Shaft- bypass			
13	1			1139-1189-01	Arm- bypass	Lever- bypass			
14	1			1139-1161-01	Låsring	Ring			
15	1			1139-1275-01	Plugg	Bore plug			
16	1			1139-1104-01	Låsring	Snap ring			
17	2			1139-1103-01	• Tätningbricka	• Seal washer.....	S		
18	2			1139-1500-01	Dräneringsskruv	Drain bolt kit			
19	2			1139-1117-01	• O- ring.....	• O- ring	S		
20	1			1139-1119-01	• Tätning	• Seal	S		
21	2			1139-1295-01	Skruv	Tapping screw.....			
22	14			1139-0244-01	Skruv	Tapping screw.....			
24	1			1139-1599-01	• Centrumhus	• Center case	R		
25	1			1139-1158-01	Stift	Pin			
26	1			1139-1405-01	• Filter	• Filter	S		
27	3			1139-1718-01	Bult	Bolt			
28	2			1139-1468-01	Ventil	IDS valve.....			
29	2			1139-1243-01	Fjäder.....	Spring			
30	2			1139-1307-01	Filter	Filter			
31	1			1139-1601-01	• Cylinderblock (pump)	• Cylinder block (pump).....	R		
32	1			1139-1245-01	Fjäder.....	Spring			
33	1			1139-1406-01	• Pumpaxel.....	• Pump shaft.....			
34	3			1139-1146-01	• Låsring	• Ring			
35	1			1139-1110-01	• Kullager	• Ball bearing			
36	1			1139-1157-01	Hus	Housing			
37	1			1139-1501-01	Lager	Bearing.....			
38	1			1139-1717-01	• Cylinderblock (motor).....	• Cylinder block (motor)	R		
39	1			1139-1160-01	Bricka	Washer.....			
40	1			1139-1353-01	Motoraxel	Motor shaft			
41	1			1139-1021-01	Låsring	Snap ring			
42	1			1139-1272-01	Motordrev.....	Motor gear			
43	1			1139-1453-01	Lager	Bearing.....			
44	2			1139-1066-01	Tryckplatta	Metal thrust			
45	1			1139-1597-01	Stänkplatta.....	Swash plate.....			
46	1			1139-1508-01	Lager	Thrust bearing kit.....			
47	1			1139-1598-01	Magnethållare.....	Magnet holder			
49	1			1139-1354-01	Regleraxel.....	Control shaft			
50	1			1139-1410-01	Excenter.....	Fulcrum.....			
51	1			1139-1312-01	Fjäder.....	Spring			
52	1			1139-1409-01	Reglerarm.....	Control arm			
53	1			1139-1325-01	Reglerarm.....	Control lever			
54	1			1139-1596-01	Ryckplatta.....	Jerky plate.....			
55	1			1139-1102-01	Bricka	Washer.....			
56	1			1139-1355-01	Saxpinne.....	Cotter pin			
57	1			1139-1329-01	Stift.....	Pin			
58	1			1139-1285-01	Stift.....	Pin			
59	2			1139-1115-01	• O- ring.....	• O- ring	S		
60	1			1139-1127-01	Mutter.....	Nut			
61	1			1139-1404-01	Differentialdrev kpl	Differential gear kit.....			
62	1			1139-1258-01	Slutdrev	Final gear			
63	1			1139-1255-01	Hylsa	Collar			
64	1			1139-1256-01	Reduktionsaxel	Reduction shaft.....			
65	2			1139-1398-01	Bricka	Washer.....			
66	1			1139-1267-01	Reduktionsdrev	Reduction gear.....			
67	1			1139-1361-01	Slutdrev	Final pinion			
68	1			1139-1342-01	Hjulaxel- vä	Axle shaft- left			
69	1			1139-1343-01	Hjulaxel- hö	Axle shaft- right.....			

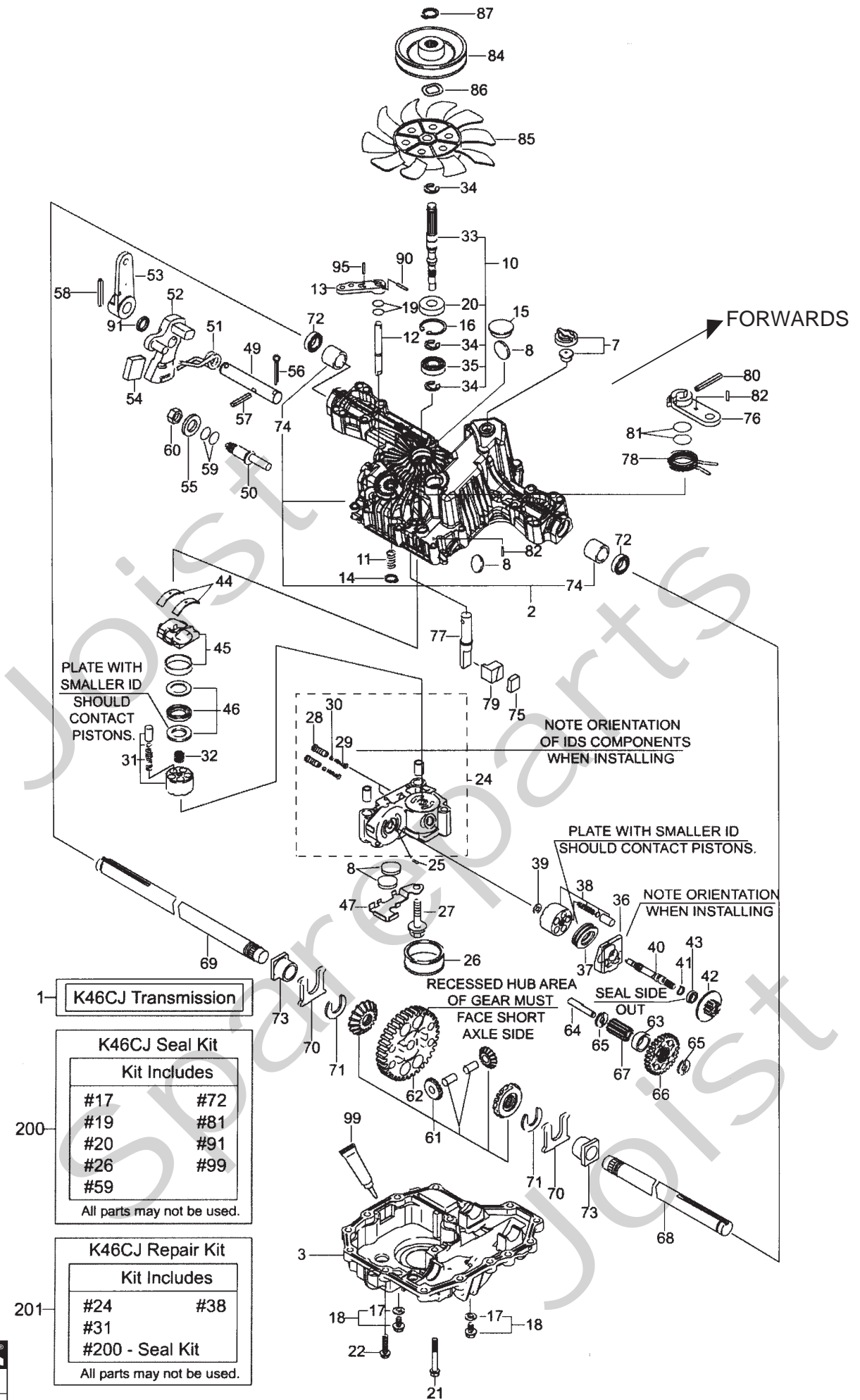

1 K46CJ Transmission

200 K46CJ Seal Kit
 Kit Includes
 #17 #72
 #19 #81
 #20 #91
 #26 #99
 #59
 All parts may not be used.

201 K46CJ Repair Kit
 Kit Includes
 #24 #38
 #31
 #200 - Seal Kit
 All parts may not be used.

Utgåva Issue 2011-11		Bildnr Picture No 2546A		KANZAKI TRANSAXEL K46CJ (s/n 0014070-9999999)		KANZAKI TRANSAXLE K46CJ (s/n 0014070-9999999)		Sida Page 440	
Pos. Fig.	Antal/Quantity				Art nr Part No	Benämning	Description	Sats Kit	Anmärkning Notes
	K46 CJ								
70	2				1139-1078-01 Tryckbricka	Thrust washer			
71	2				1139-1163-01 Låsring	Ring			
72	2				1139-1080-01 • Tätning	• Seal	S		
73	2				1139-1164-01 Bussning	Bushing			
74	2				1139-1414-01 • Bussning	• Bushing			
75	1				1139-1260-01 Bromssko	Brake shoe			
76	1				1139-1261-01 Bromsarm	Brake arm			
77	1				1139-1320-01 Bromsaxel	Brake shaft			
78	1				1139-1411-01 Returfjäder	Return spring			
79	1				1139-1264-01 Bromstryckare	Brake actuator			
80	1				1139-1282-01 Stift	Pin			
81	2				1139-1114-01 • O-ring	• O-ring	S		
82	2				1139-1281-01 Stift	Pin			
84	1				1139-1484-01 Remskiva	Belt pulley			
85	1				1134-4190-01 Fläkt	Fan			
86	1				1139-1266-01 Låsbricka	Lock washer			
87	1				1139-1149-01 Låsring	Snap ring			
90	1				1139-1280-01 Stift	Pin			
91	1				1139-1303-01 • Tätningsring	• Oil seal	S		
95	1				1139-1279-01 Stift	Pin			
99	1				1139-1443-01 • Tätningsmedel	• Sealant	S		
200	1				1139-1403-01 Packningssats	Seal kit	R		Märkta S/Marked S
201	1				1139-1600-01 Rep.sats	Repair kit			Märkta R/Marked R