

PARK 16HST, 18HST

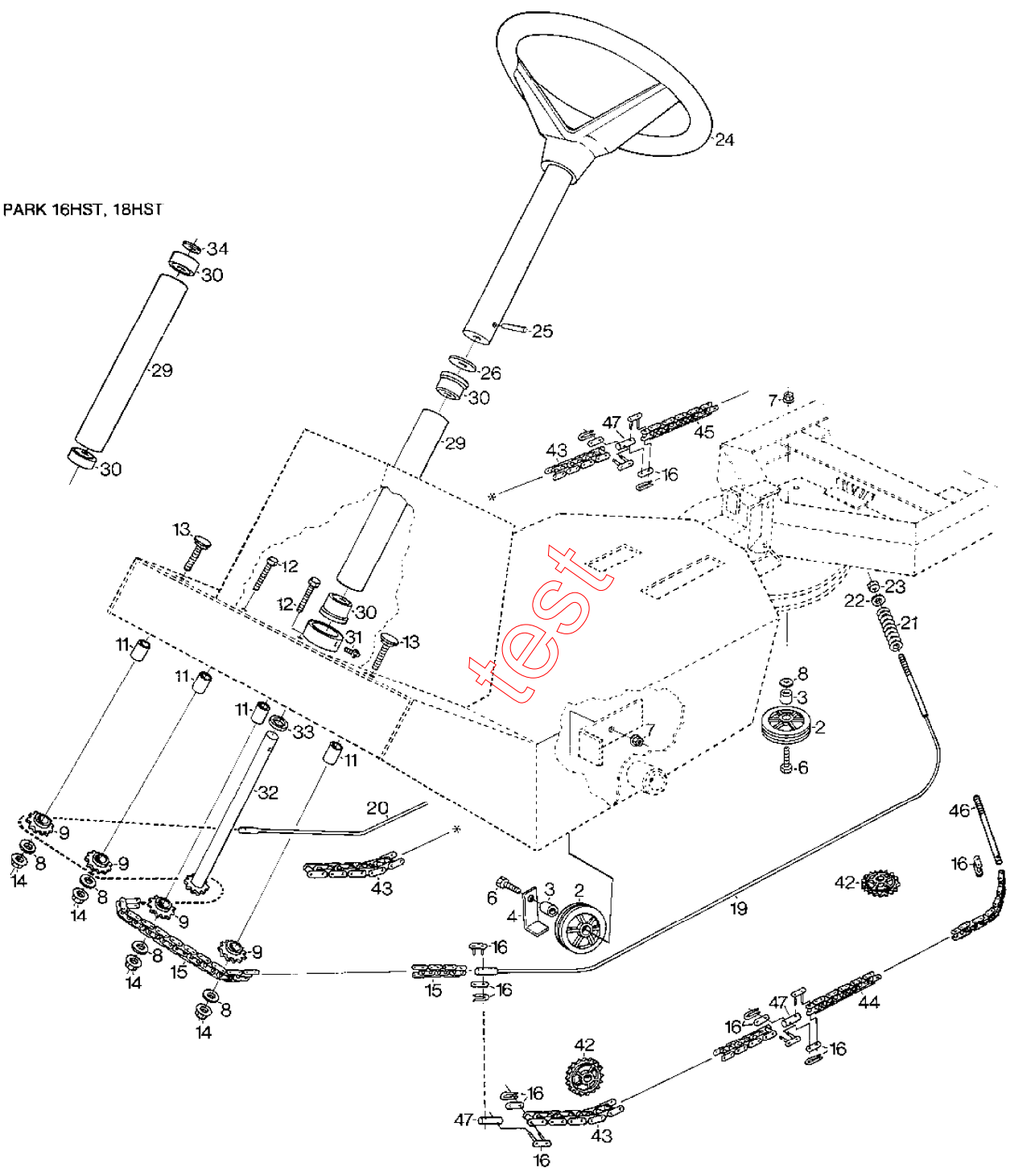

Section: PARK STEERING

Pos.	Quantity		Spare part No	Description	Kit	Notes	New
	1168	1358	1458	1818			
	1442	1443	1446	1448			
2	2	2		1134-9025-01	Steering pulley-kit	Innehåller/contains	
3	3	3	3	1134-0041-01	Bushing		
4	2	2	2	1134-3022-01	Cable holder		
6	3	3	3	9997-1030-16	Screw		
7	3	3	3	9739-1031-22	Nut		
8	5	5	5	9699-0035-02	Flat washer		
9	4	4	4	1134-2816-01	Sprocket		
11	4	4	4	1134-0041-02	Idler wheel bush		
12	2	2	2	9997-1040-12	Screw		
13	2	2	2	9897-1040-12	Screw		
14	4	4	4	9739-1031-22	Nut		
15	1	1	1	1134-2820-01	Chain w/o lock	79 länk/links	
16	2	2	10	1134-2824-01	Chain lock		
19	1	1		1134-2817-01	Steering cable-LH	L=939 mm	
20	1	1		1134-2817-02	Steering cable-RH	L=990 mm	
21	2	2	2	1134-2818-01	Spring		
22	2	2	2	9699-0090-02	Flat washer		
23	2	2	2	9747-0831-02	Lock nut		
24	1	1	1	1134-1966-03	Steering wheel		
25	1	1	1	9595-0262-00	Locating pin		
26	1	1	1	9699-0103-02	Flat washer	0.5 mm	
26	1	1	1	9699-0114-02	Flat washer	1.0 mm	
29	1	1		1134-1305-03	Steering column-low		
29			1	1134-3085-01	Steering column-low		
30	2	2		1134-1901-01	Bearing		
30			2	9549-0017-00	Ball bearing		
31	2	2	2	9942-0612-16	Screw		
32	1	1		1134-2821-01	Steering rod		
32			1	1134-3084-01	Steering rod		
33			1	1134-2837-02	Spacer		
33	1	1		1134-2837-01	Spacer		
34			1	9695-0011-00	Washer		
42			3	1134-3547-01	Sprocket		
43			2	1134-2820-02	Chain	41 länk/links	
44			1	1134-2820-04	Chain	41 länk/links	
45			1	1134-2820-02	Chain	45 länk/links	
46			2	1134-3550-01	End nipple		
47			4	1134-3565-01	Connection nipple		