



IPL, Vision Compact 350 Plus, 9633524-01, 2005-11

Vision Compact 350 Plus



Factory:
Product Group:
Sub Group:
Publication Date:
Publication Number:

FLM - Newton Aycliffe
OM 78
Electric Hover: 7890
24/11/05
AP0511003

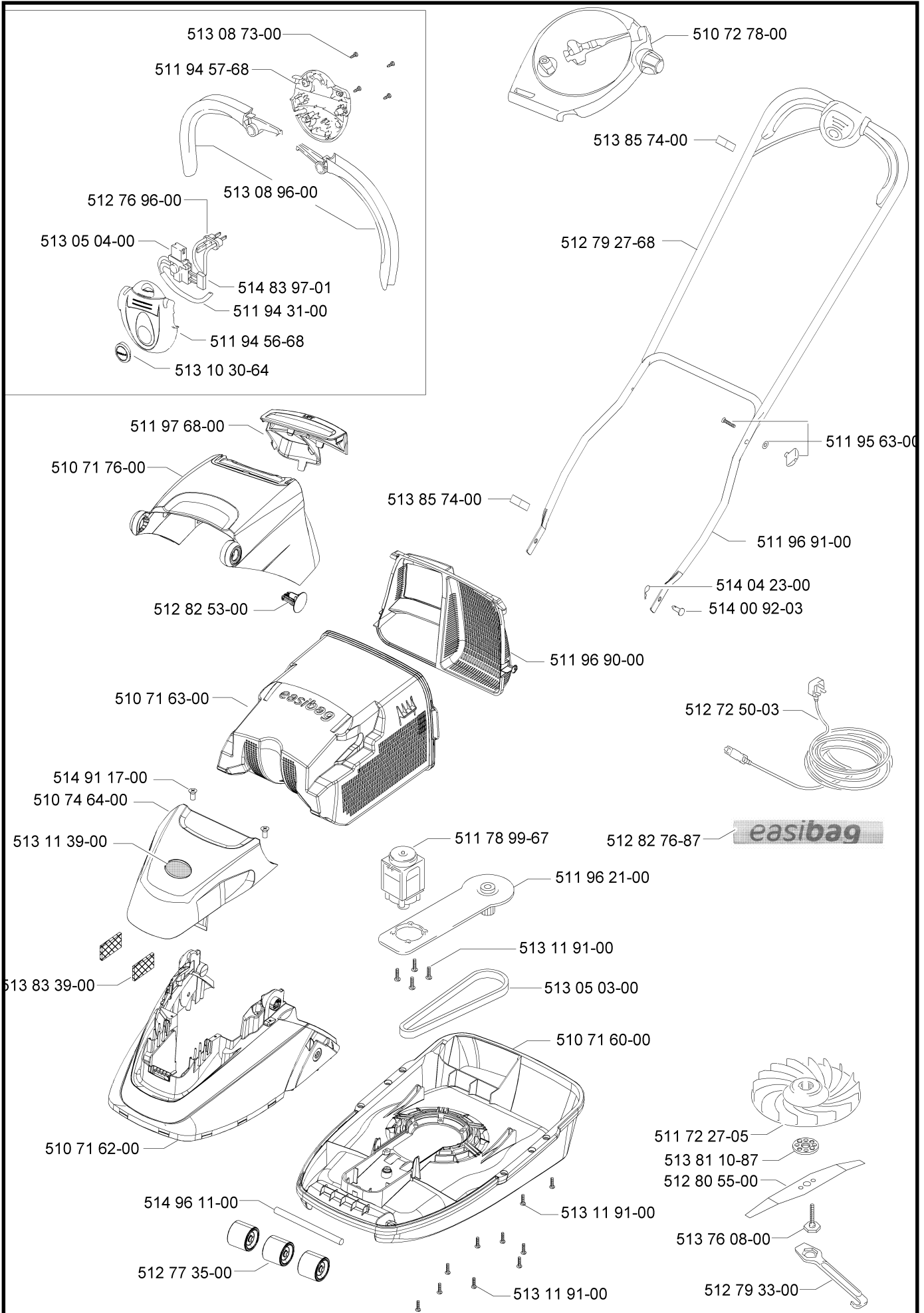

IPL, Vision Compact 350 Plus, 9633524-01, 2005-11

Part Number	Description	Qty	Note
510 71 60-00	HOOD EASIBAG 330	1	
510 71 62-00	CASING EASIBAG 330	1	
510 71 63-00	GRASSBOX EASIBAG 330	1	
510 71 76-00	LID VC350+	1	
510 74 64-00	COVER MOTOR PRINTED VC350+	1	
511 72 27-05	IMPELLER TC	1	
511 78 99-67	MOTOR AMETEK	1	
511 94 31-00	LEAD ASSY	1	
511 94 56-68	SWITCHBOX UPPER GREY	1	
511 94 57-68	SWITCHBOX LOWER UK GREY	1	UK
511 96 21-00	DRIVE ASSY CV330/350	1	
511 96 90-00	SCREEN EASIBAG 330	1	
511 96 91-00	HANDLE LOWER EASIBAG 330	1	
511 97 68-00	WINDOW VISION	1	
512 76 96-00	PIN - RETAINER ASSY UK E330	1	UK
512 77 35-00	ROLLER-SEGMENT	3	
512 79 27-68	HANDLE UPPER-PLASTIC COATED	1	
512 79 33-00	ABS SPANNER (PLASTIC)	1	
512 80 55-00	BLADE 35CM	1	
512 82 53-00	PIVOT PIN CLIP EASIBAG 330	2	
512 82 76-87	BAG COMPOSTABLE (Qty 10)	1	
513 05 03-00	BELT	1	
513 05 04-00	SWITCH 8A 250V	1	
513 08 73-00	SCREW NO6X19 POLYMATE PAN/HD 4	4	
513 08 96-00	SWITCHBOX LEVERS KIT	1	
513 10 30-64	BUTTON LOCK-OFF ORANGE	1	
513 11 39-00	BADGE	1	
513 11 91-00	Screw-Cap. Washer 6 Spline	16	
513 76 08-00	BLADE BOLT ASSY (BROWN)	1	
513 81 10-01	BLADE SPACER	3	
513 83 39-00	FILTER	2	
513 85 74-00	CABLE CLIP	2	
513 85 87-00	LABEL:WARNING (ELECTRIC)	1	
514 00 92-03	PIVOT PIN	2	
514 04 23-00	SPRING CLIP SMALL	2	
514 83 97-01	CAPACITOR PWR.HOE/MULTI TRIM	1	
514 91 17-00	SCREW	2	
514 96 11-00	AXLE TUBE	1	