

MODEL Power Compact 400

9644403-01	9644403-22	9644403-67	9644403-86
GB.EI	CH	E.EURO	EURO

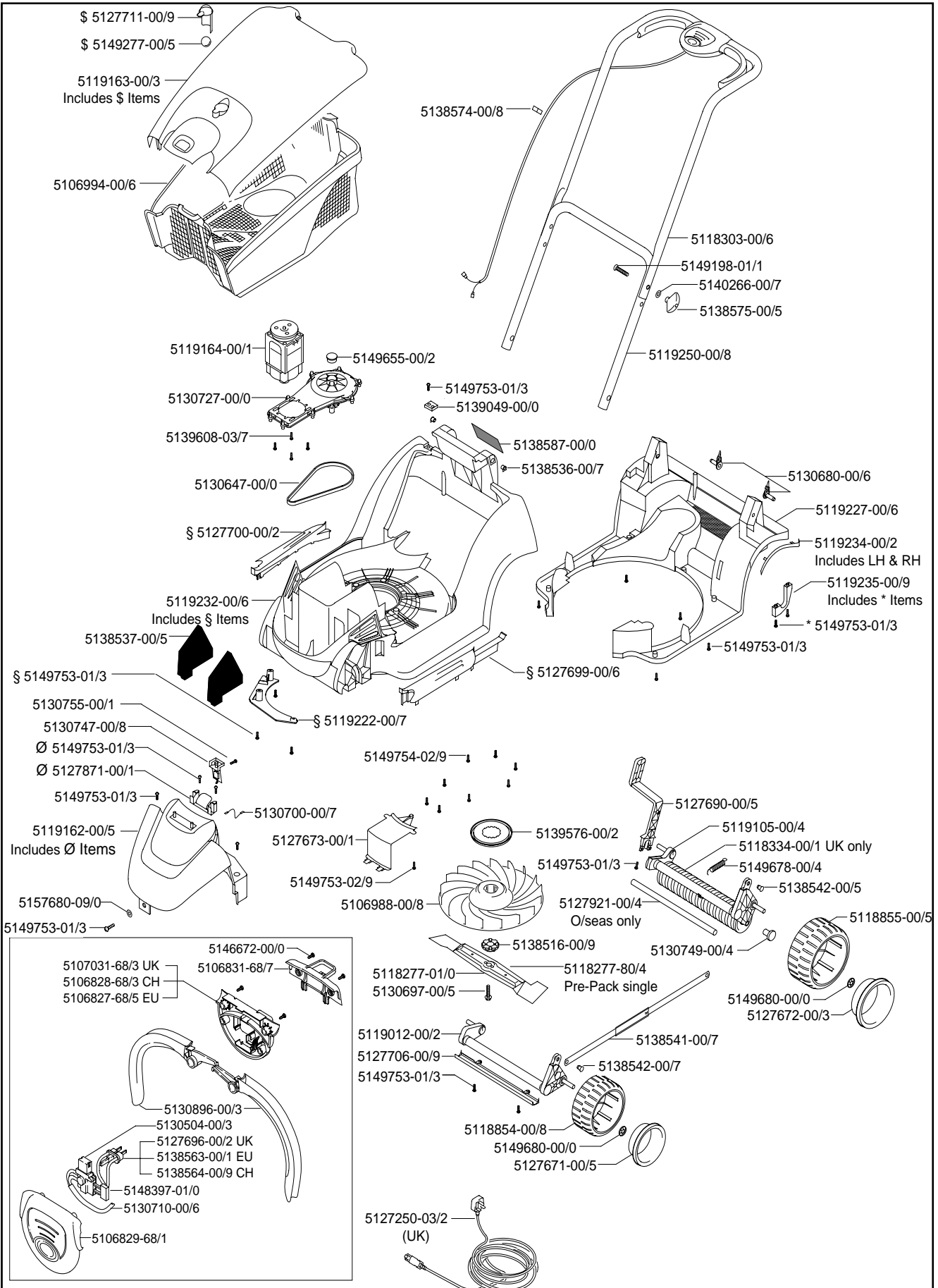



POWER

compact 400

Advanced electric wheeled lawnmower

- The Powerful, Compact and Lightweight lawnmower with a “unique” central grassbox for easy emptying.
- Collects and Compacts more grass for less emptying.
- Powerful 1700W motor with belt drive system for cutting in tough conditions.
- Unique, advanced switch system for easy, comfortable right or left handed use.
- Compact design, for easy storage and manoeuvrability.
- Grassbox full indicator that tells you when to empty the grassbox.
- Electric interlock for extra safety.
- Rubber wheel tread.
- Central height adjuster.
- Rear roller for stripes.

Features

Motor Power	1700 W
Cutting Width	40 cm
Heights of cut	6 (12 - 75mm)
Grassbox Capacity	38 Litres
Wheel Tread	Rubber
Adjuster	Central
Carton Dimensions	804x564x510 mm
Weight (Unpacked)	14 Kg
Weight (Packed)	18.5 Kg